

Mode 1

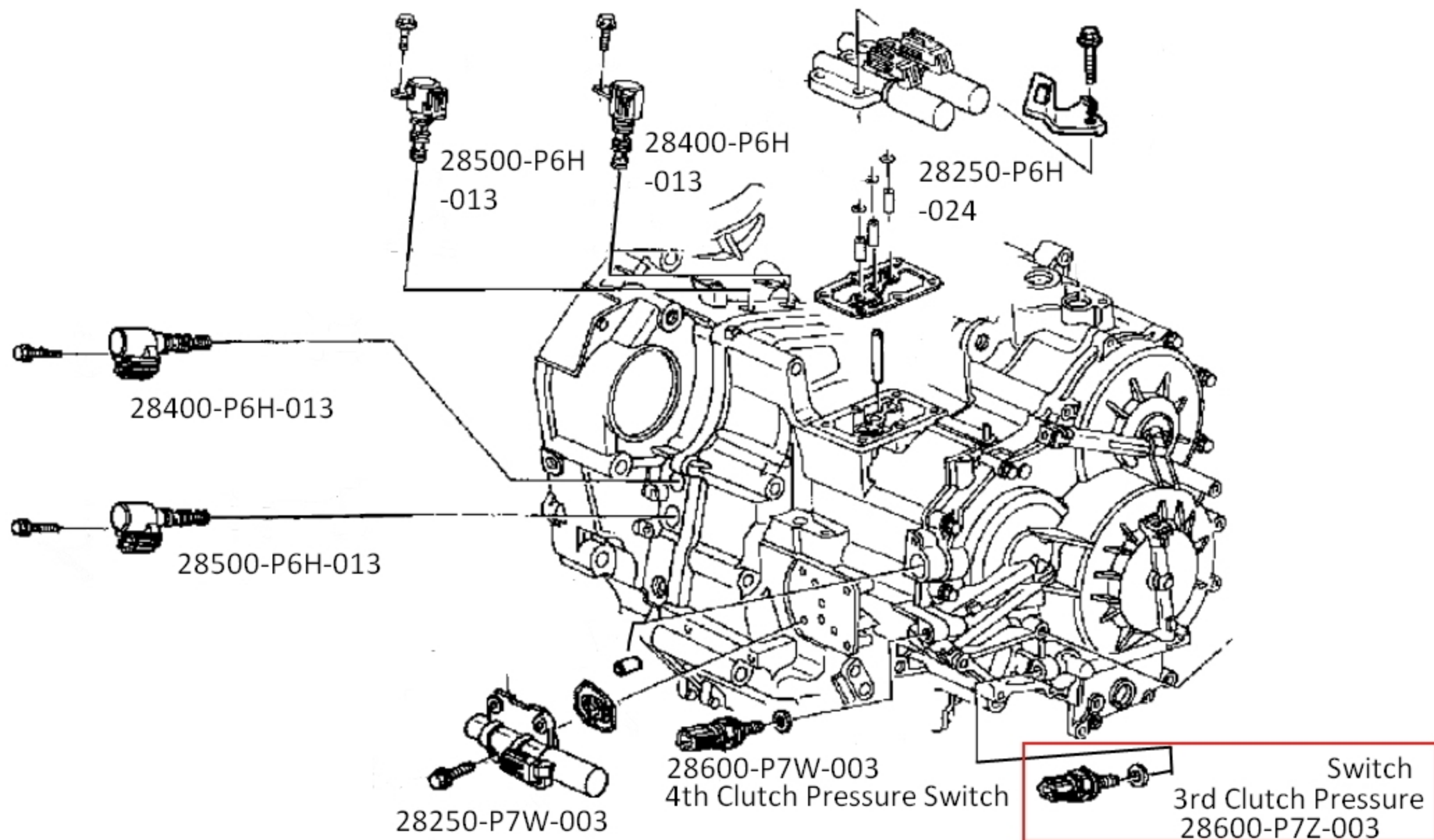

3rd Clutch Transmission Fluid Pressure Switch Replacement

1. Lift the vehicle up on a lift or apply the parking brake, block rear wheels, and raise the front of the vehicle. Make sure it is securely supported.
2. Remove the splash shield.
3. Disconnect the ATF temperature sensor connector (A), and remove it from its bracket.
4. Remove ATF temperature sensor harness clamp bolts (B).
5. Disconnect the connector from the 3rd clutch transmission fluid pressure switch (C).
6. Remove the switch, then install a new one with a new sealing washer (D). Do not tighten the switch using the plastic connector.
7. Check the connector for water, corrosion, dust, and oil, then connect the connector securely.
8. Install ATF temperature sensor harness clamp bolt, and connect the ATF temperature sensor connector.
9. Install the splash shield.

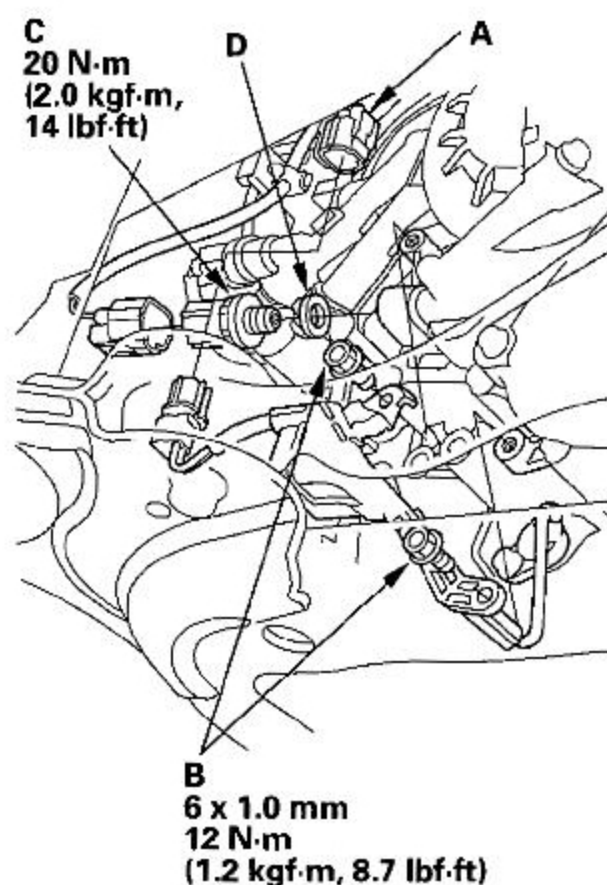

Application:

5AT	
Honda Odyssey	2002-2004
Honda Pilot	2003-2004
Acura CL	2002-2003
Acura MDX	2001-2002
Acura TL	2000-2003

Mode 2

28250-P6H-024

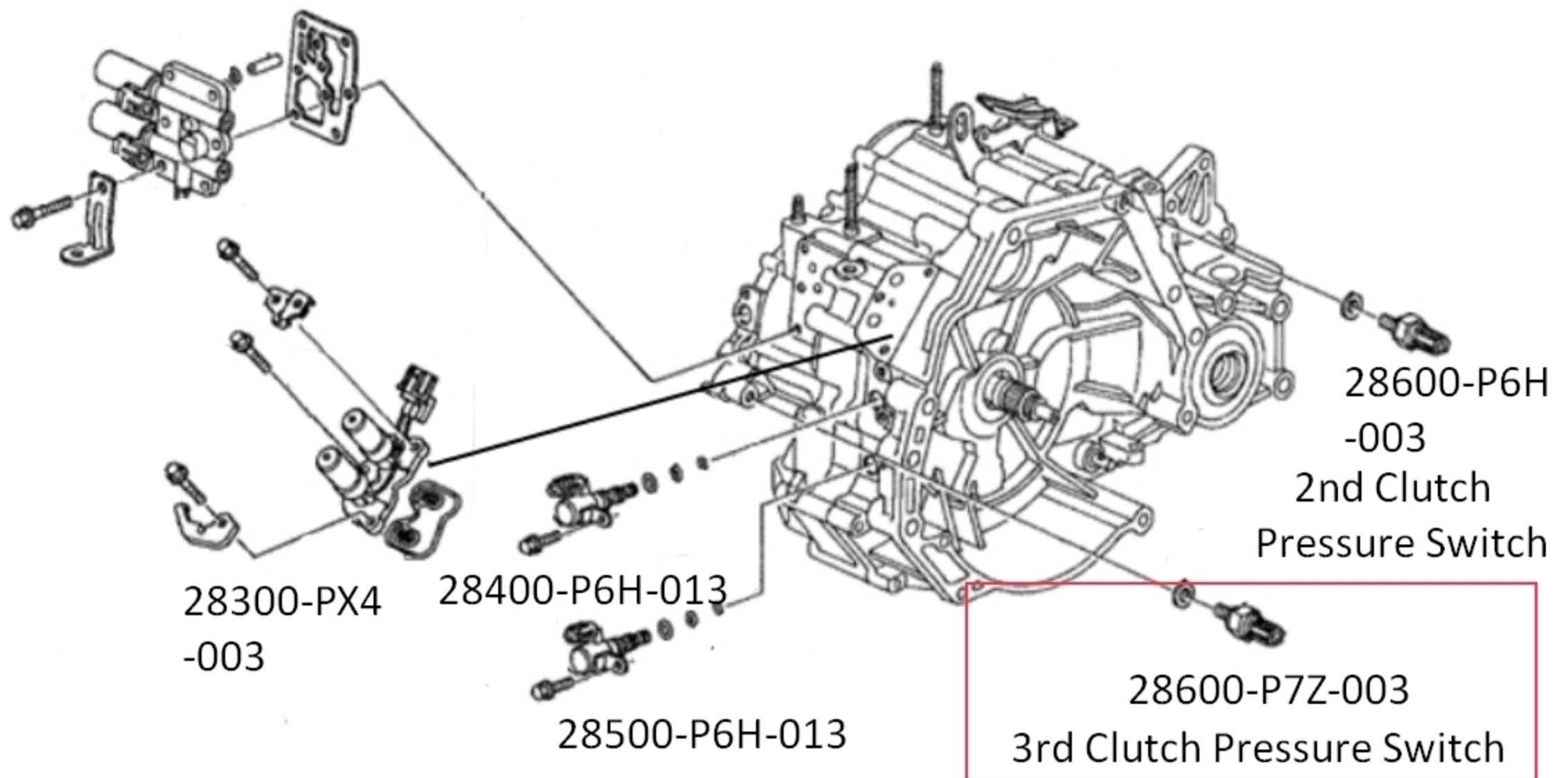

3rd Clutch Pressure Switch Replacement

1. Disconnect the connector from the 3rd clutch pressure switch.

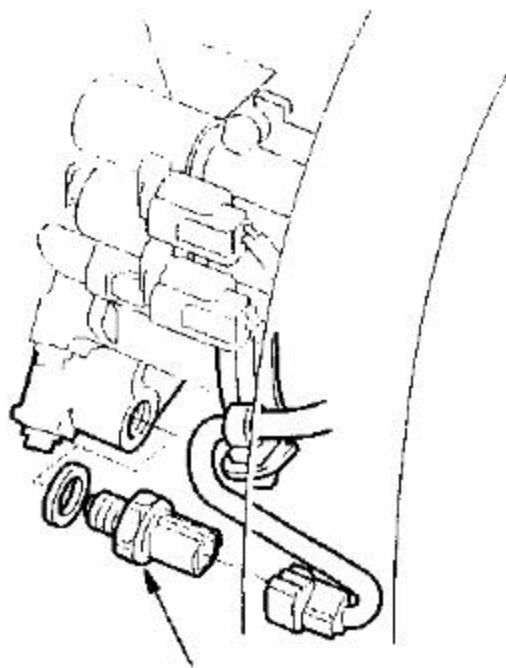

20 N·m (2.0 kgf·m, 14 lbf·ft)

2. Replace the 3rd clutch pressure switch, then install a new one with a new sealing washer. Tighten the switch on the metal part, not the plastic part.
3. Reconnect the connector, making sure there is no water, oil, dust, or other foreign particles inside it.

Application:

4AT

Honda Accord L4 1998-2002

Acura CL 1998-1999

Mode 3

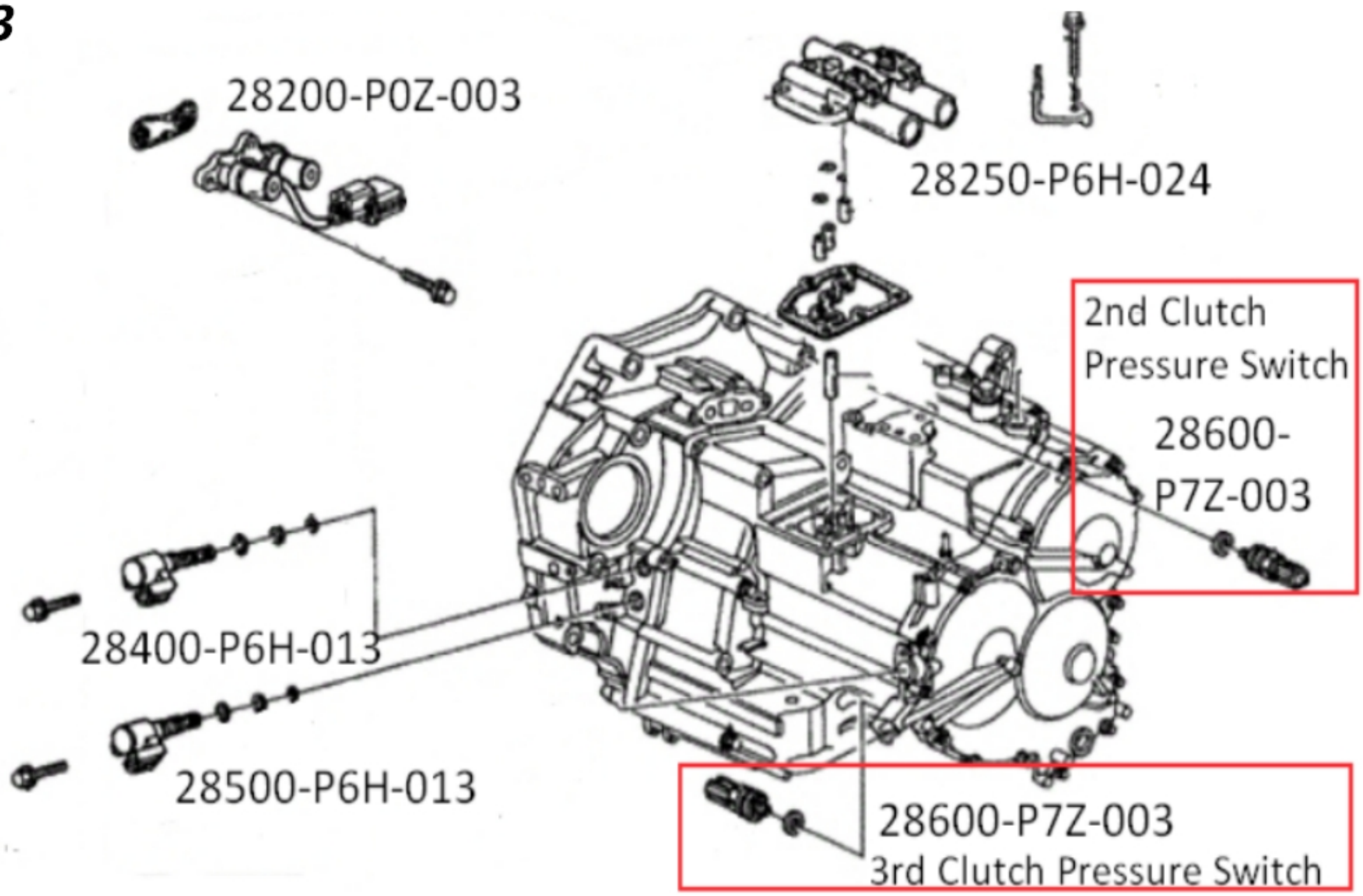

2nd Clutch Pressure Switch Replacement

1. Support the transmission with a transmission jack.
2. Remove the rear mount bracket bolts.
3. Remove the rear mount nut (A), then remove the rear mount bracket (B).
4. Remove the rear stiffener (A).
5. Disconnect the 2nd clutch pressure switch connector.
6. Replace the 2nd clutch pressure switch (A), then install a new one with a new sealing washer (B). Tighten the switch on the metal part, not the plastic part.
7. Install the rear stiffener (A), then tighten the 10 x 1.25 mm bolt (B) to the specified torque.
8. Secure the nut (C) by your hand until it contacts the stiffener, then tighten it to the specified torque. If you can not tighten the nut to the stiffener surface by hand, replace the nut and the special bolt (D).
9. Reconnect the connector, making sure there is no water, oil, dust, or other foreign particles inside it.
10. Install the rear mount bracket, and loosely tighten the rear mount nut.
11. Install the rear mount bracket bolts.
12. Tighten the rear mount nut to the specified torque.

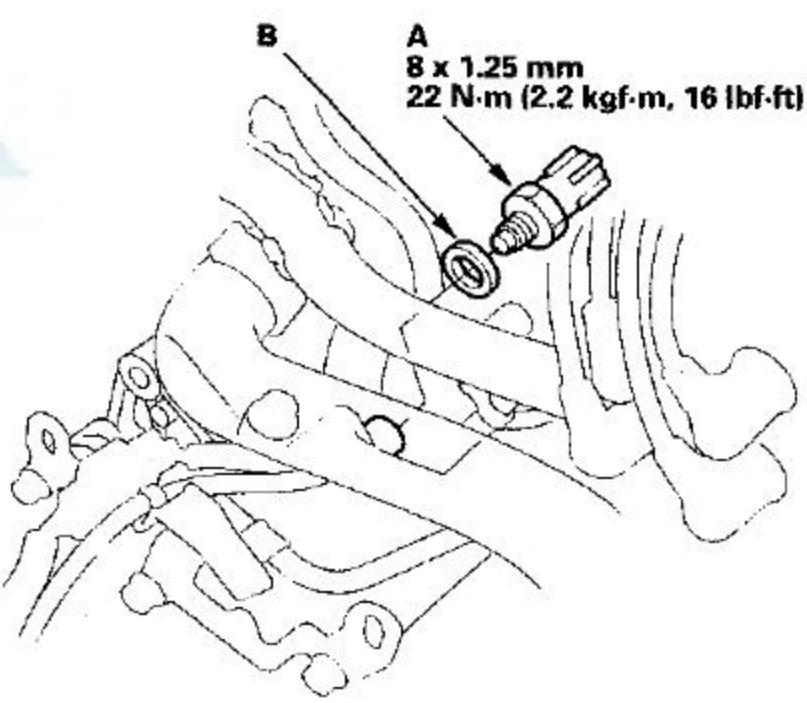

3rd Clutch Pressure Switch Replacement

1. Disconnect the connector from the 3rd clutch pressure switch.
2. Replace the 3rd clutch pressure switch, then install a new one with a new sealing washer. Tighten the switch on the metal part, not the plastic part.
3. Reconnect the connector, making sure there is no water, oil, dust, or other foreign particles inside it.

Application:	
4AT	
Honda Accord V6	1998-2002
Honda Odyssey	1999-2001
Acura CL	1997-1999