

28250-P6H-024

Mode 1

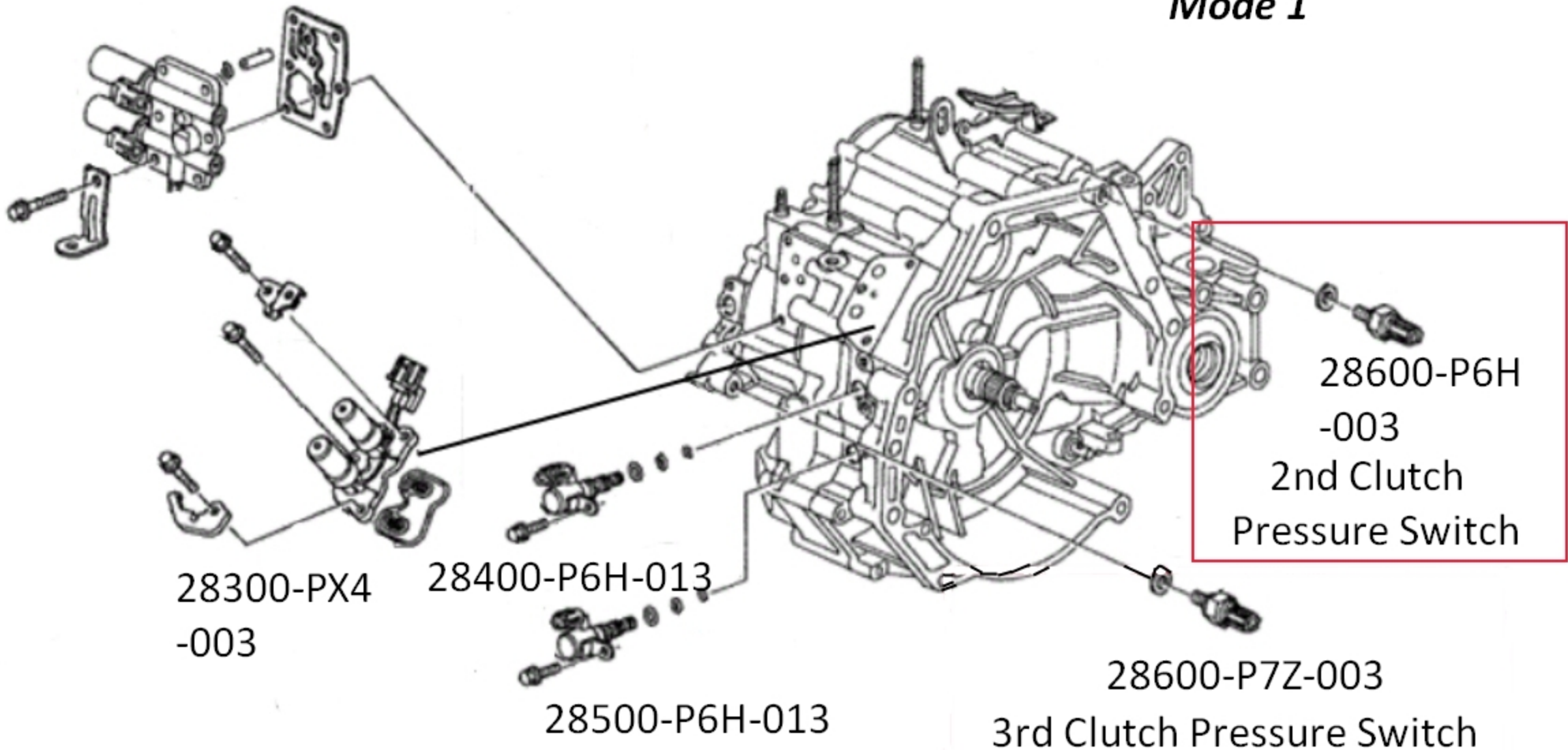

2nd Clutch Pressure Switch ('98-00 Models) Replacement

1. Remove the rear stiffener (A).

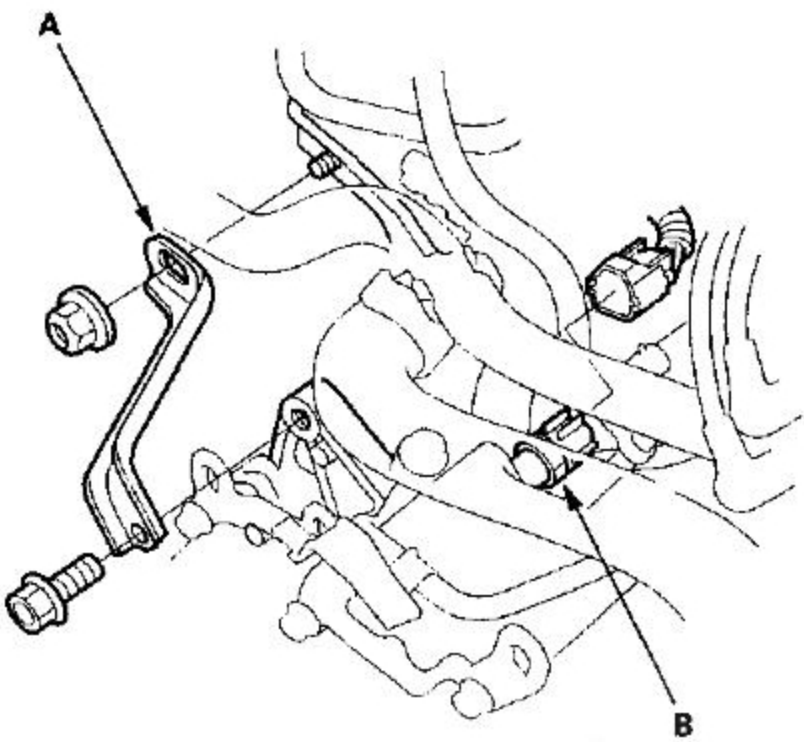

2. Disconnect the 2nd clutch pressure switch connector (B).
3. Replace the 2nd clutch pressure switch, then install a new one with a new sealing washer. Tighten the switch on the metal part, not the plastic part.

20 N·m
(2.0 kgf·m, 14 lbf·ft)

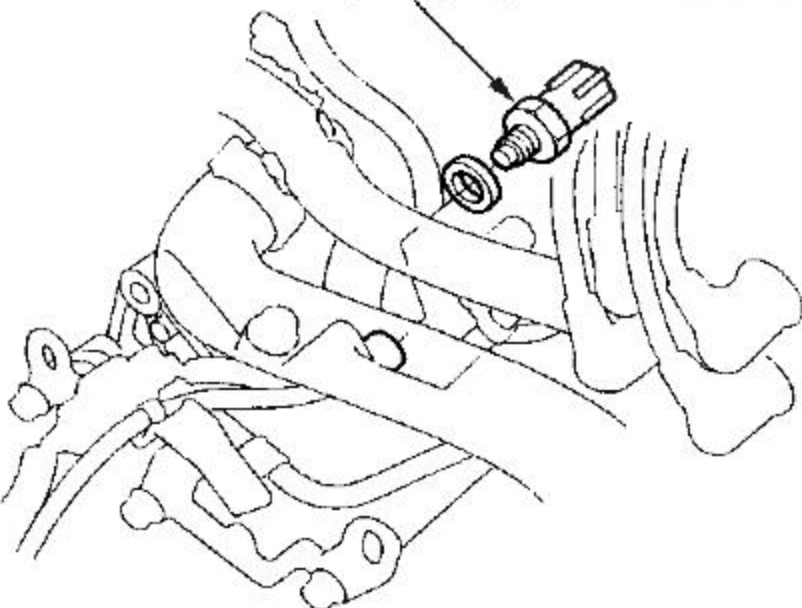

4. Reconnect the connector (A), making sure there is no water, oil, dust, or other foreign particles inside it.

10 x 1.25 mm
38 N·m (3.9 kgf·m, 28 lbf·ft)

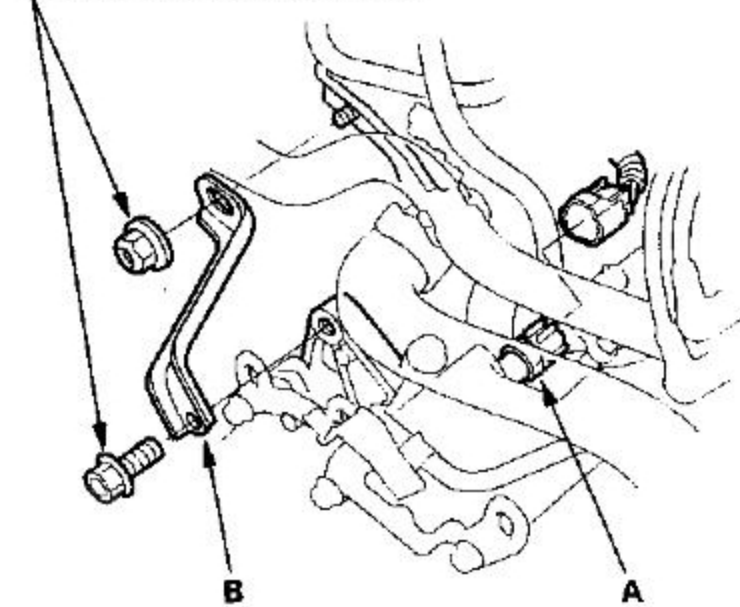

5. Install the rear stiffener (B).

2nd Clutch Pressure Switch ('01-02 Models) Replacement

1. Support the transmission with a transmission jack.
2. Remove the rear mount bracket bolts.

10 x 1.25 mm
44 N·m (4.5 kgf·m, 33 lbf·ft)

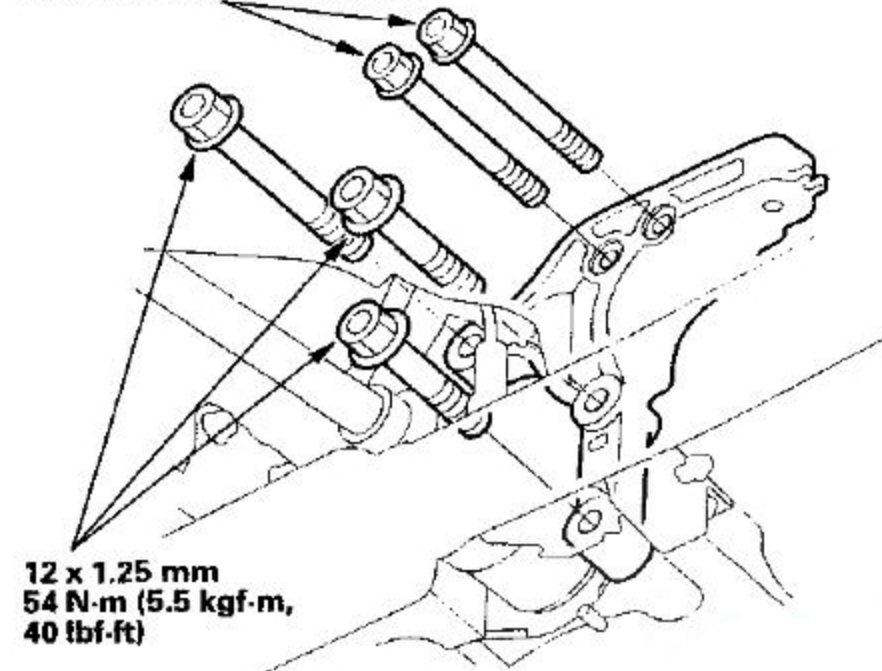

- Remove the rear mount nut (A), then remove the rear mount bracket (B).

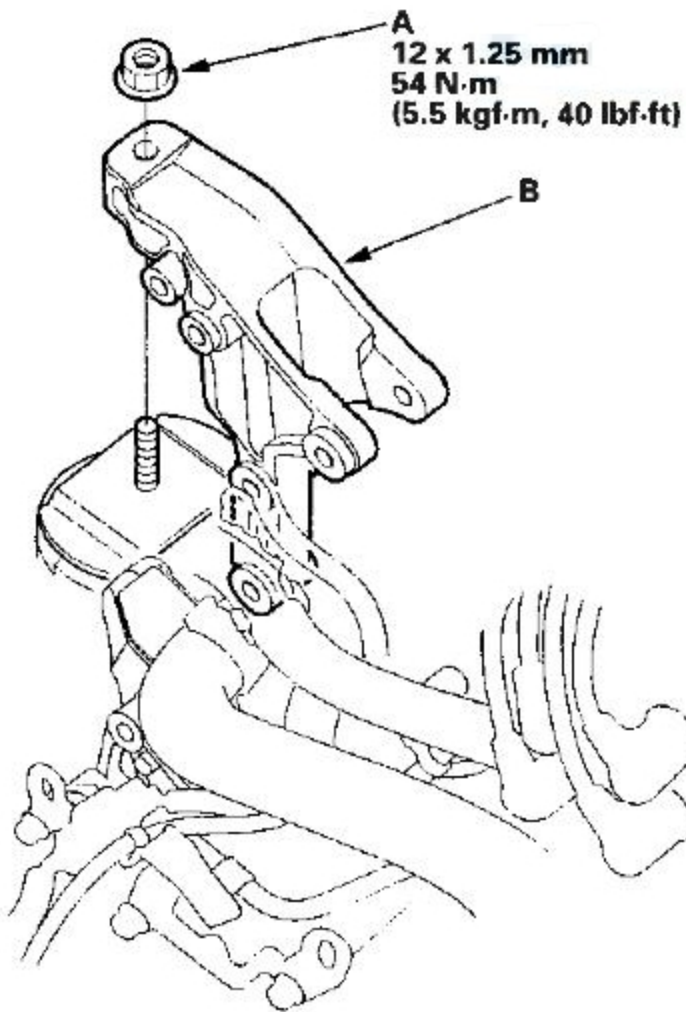

A
12 x 1.25 mm
54 N·m
(5.5 kgf·m, 40 lbf·ft)

- Install the rear stiffener (A), then tighten the 10 x 1.25 mm bolt (B) to the specified torque.

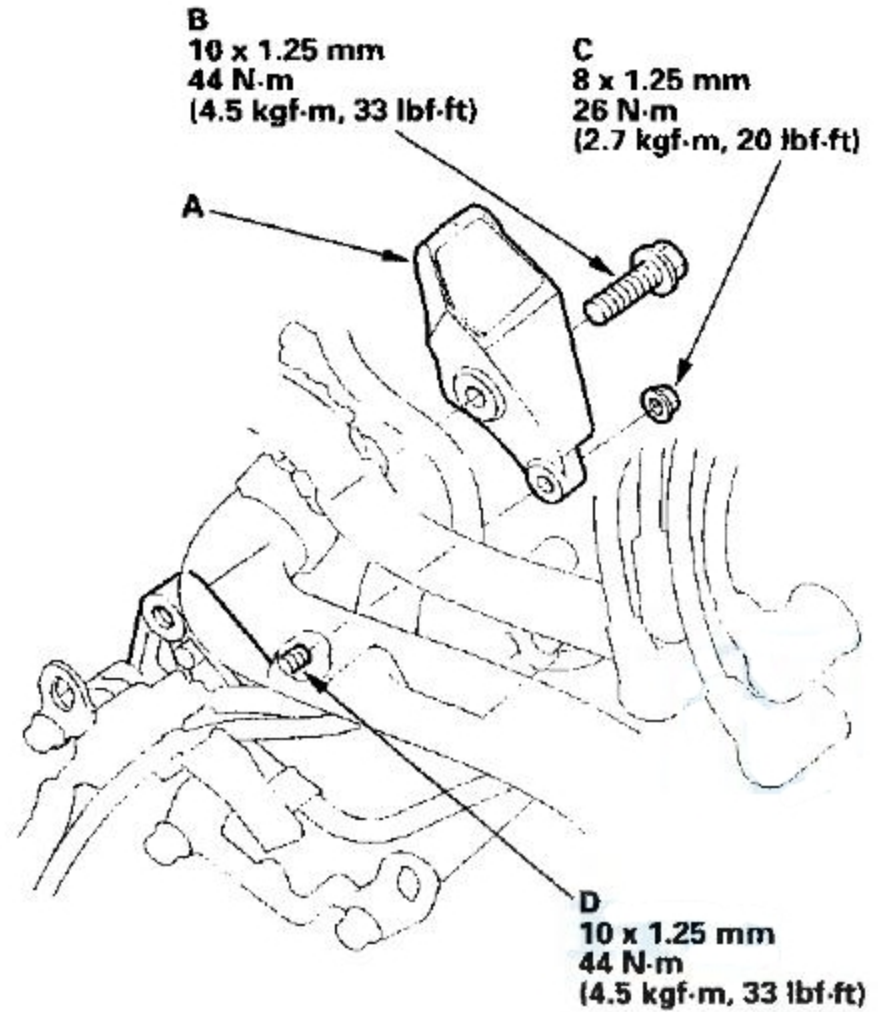

B
10 x 1.25 mm
44 N·m
(4.5 kgf·m, 33 lbf·ft)

C
8 x 1.25 mm
26 N·m
(2.7 kgf·m, 20 lbf·ft)

D
10 x 1.25 mm
44 N·m
(4.5 kgf·m, 33 lbf·ft)

- Remove the rear stiffener (A).

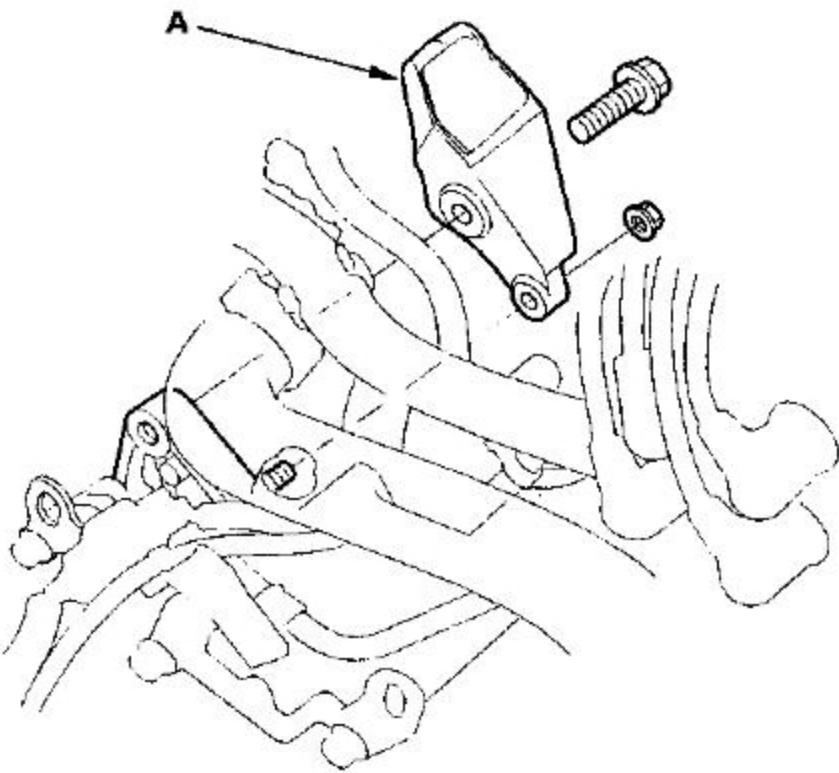

- Secure the nut (C) by your hand until it contacts the stiffener, then tighten it to the specified torque. If you can not tighten the nut to the stiffener surface by hand, replace the nut and the special bolt (D).

- Reconnect the connector, making sure there is no water, oil, dust, or other foreign particles inside it.

- Install the rear mount bracket, and loosely tighten the rear mount nut.

- Install the rear mount bracket bolts.

- Tighten the rear mount nut to the specified torque.

- Disconnect the 2nd clutch pressure switch connector.

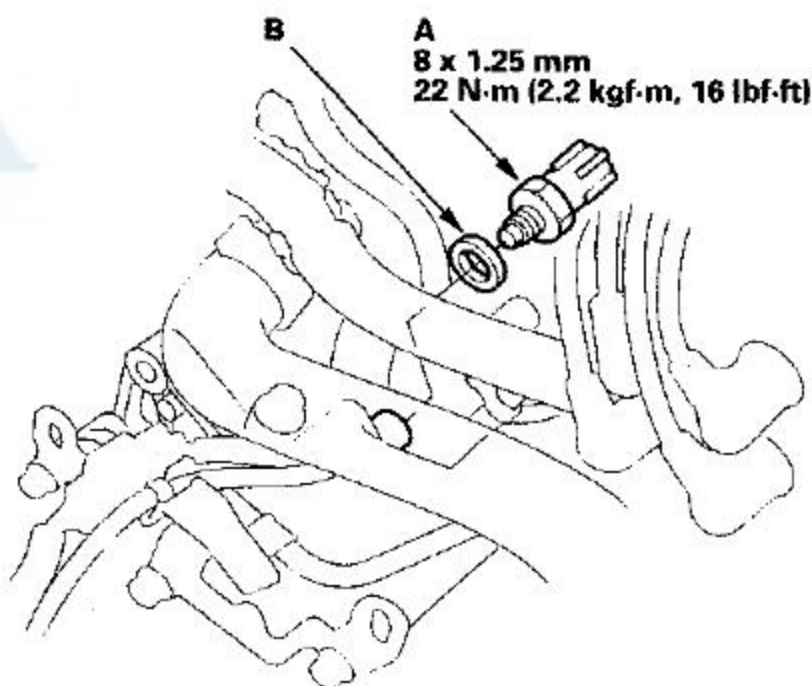

A
8 x 1.25 mm
22 N·m (2.2 kgf·m, 16 lbf·ft)

- Replace the 2nd clutch pressure switch (A), then install a new one with a new sealing washer (B). Tighten the switch on the metal part, not the plastic part.

Application:

4AT

Honda Accord L4 1998-2002

Acura CL 1998-1999

Mode 2

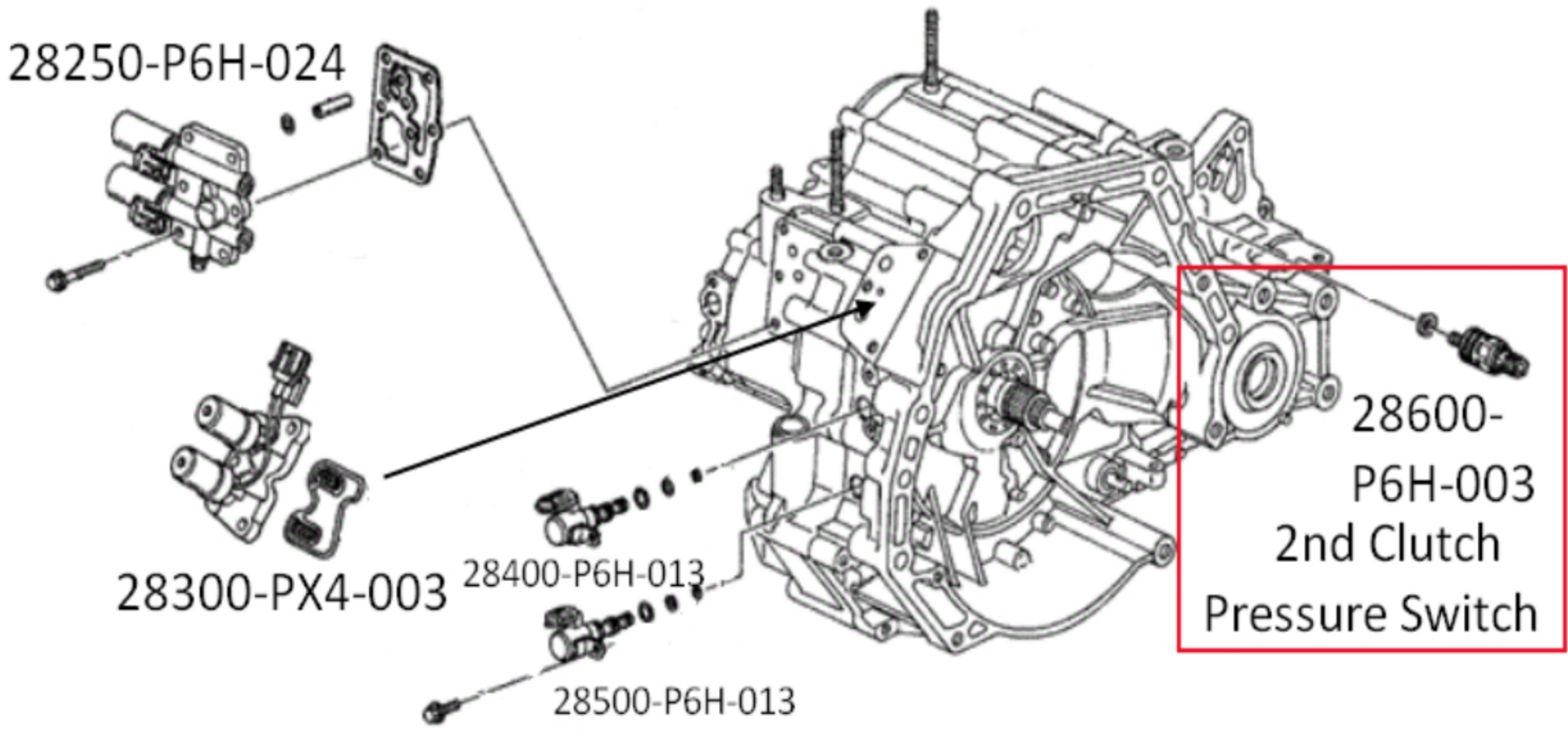

2nd Clutch Pressure Switch Replacement

1. Disconnect the connector from the 2nd clutch pressure switch.
2. Replace the 2nd clutch pressure switch, then install a new one with a new sealing washer.

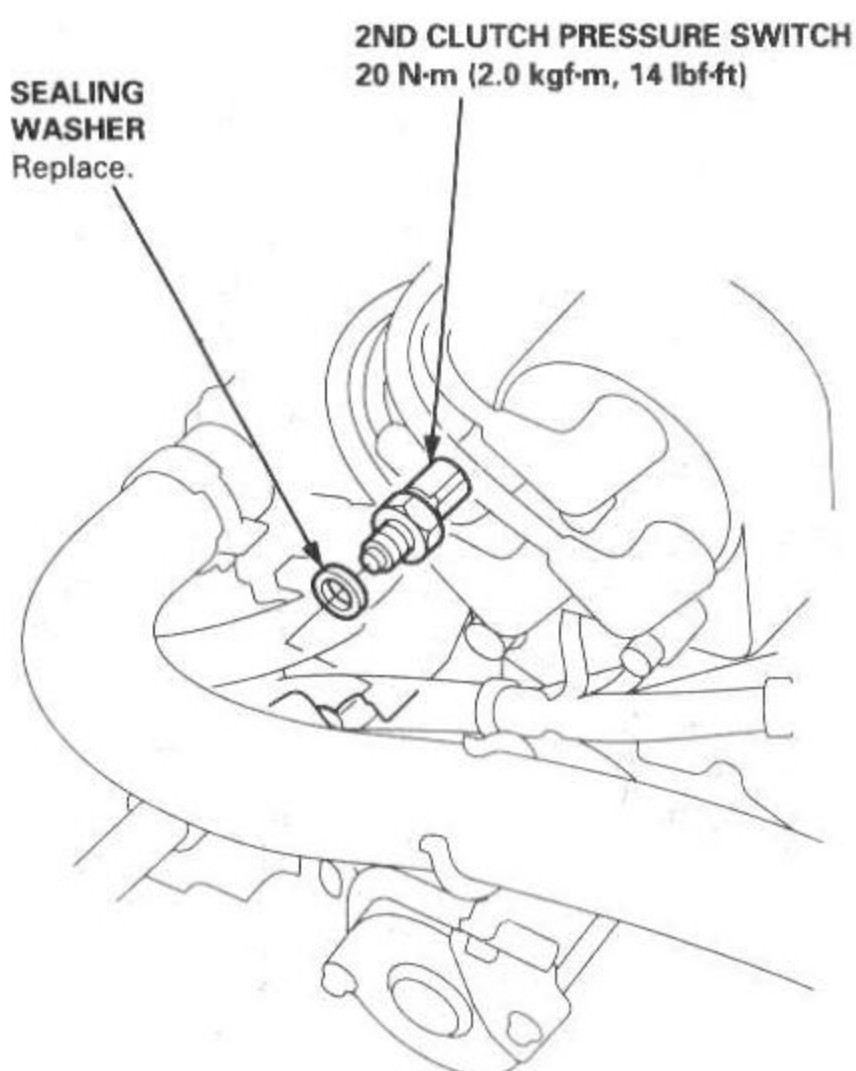

Application:
4AT
Honda Prelude 1997-2001

3. Tighten the 2nd clutch pressure switch on the metal part of the switch, not the plastic part. Do not allow water, fluid, oil, dust, or other foreign particles to get inside the connector.