

TRANSMISSION DISASSEMBLY

1. Remove the oil pan and oil pan gasket, as shown in Figure 2.
Note: There are 2 different oil pans and cases, one version has 8 bolts and one has 16 bolts, as shown in Figure 1 and 2.
2. Remove the 3 filter retaining bolts and the oil filter, as shown in Figure 4.
3. Remove and discard the oil filter to valve body "O" ring seal, as shown in Figure 4.
4. Install new "O" ring seal on new oil filter as shown in Figure 236, and lube "O" ring with a small amount of *SINS*.
5. Install oil filter and torque the 3 retaining bolts to 11 N·m (97 in.lb.) (See Figure 4).
6. Install the five oil pan magnets between the ribs provided in the oil pan, as shown in Figure 5.
7. Install new oil pan gasket on the oil pan, as shown in Figure 3.
8. Install the oil pan and gasket onto the case, as shown in Figure 3.
9. Install the required amount of oil pan retaining bolts and torque to 11 N·m (97 in.lb.).
Note: Some models require 8 bolts and some models require 16 bolts as cases are different. Refer to Fig. 1.
10. Install new "O" ring on oil pan "check" plug, as shown in Figure 3, and torque check plug to 28 N·m (20 ft.lb.).

Transmission Case

We have seen 2 different styles of the transmission case in 2 different locations. First, the number of pan bolts vary between 8 and 16, as shown in Figure 1 and 2.

Case For 8 Bolt Oil Pan

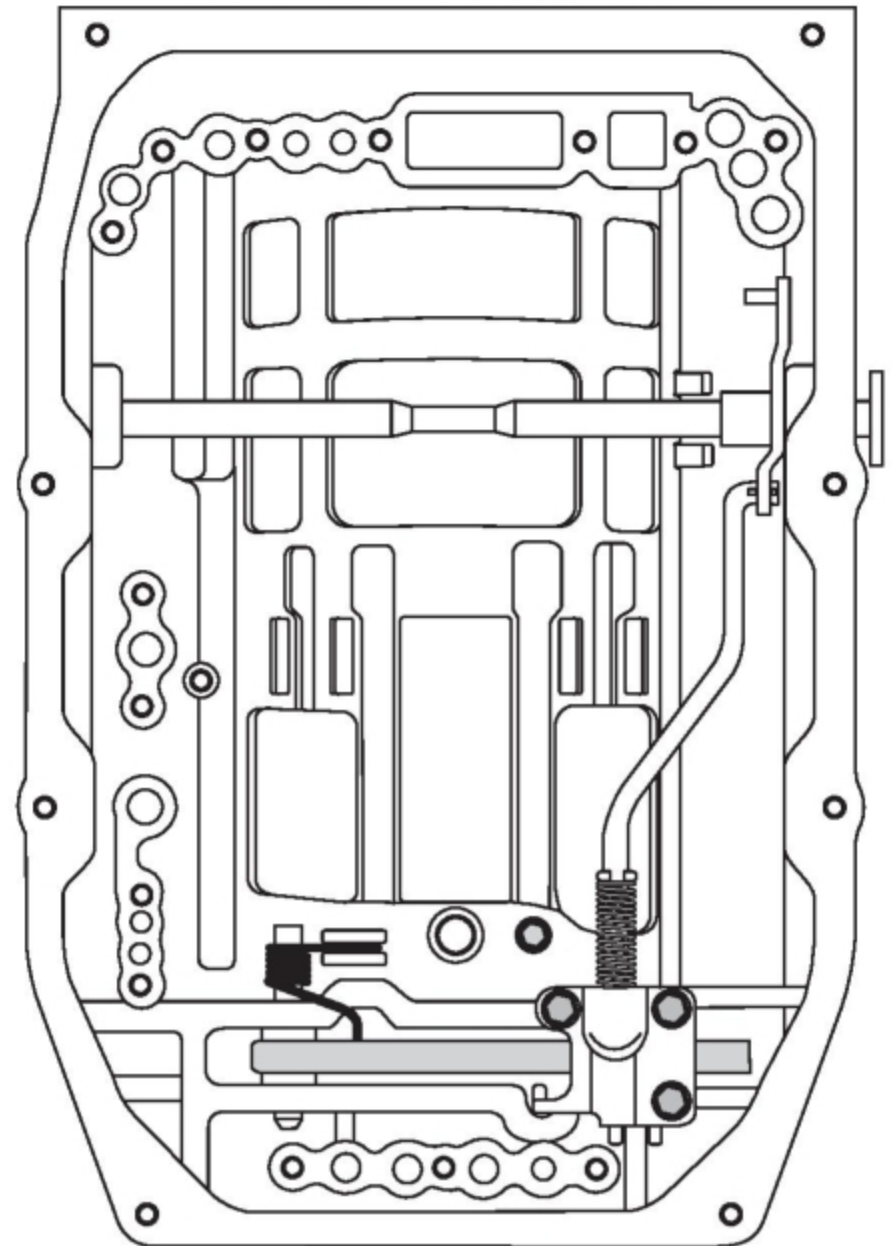

Fig.1

Case For 16 Bolt Oil Pan

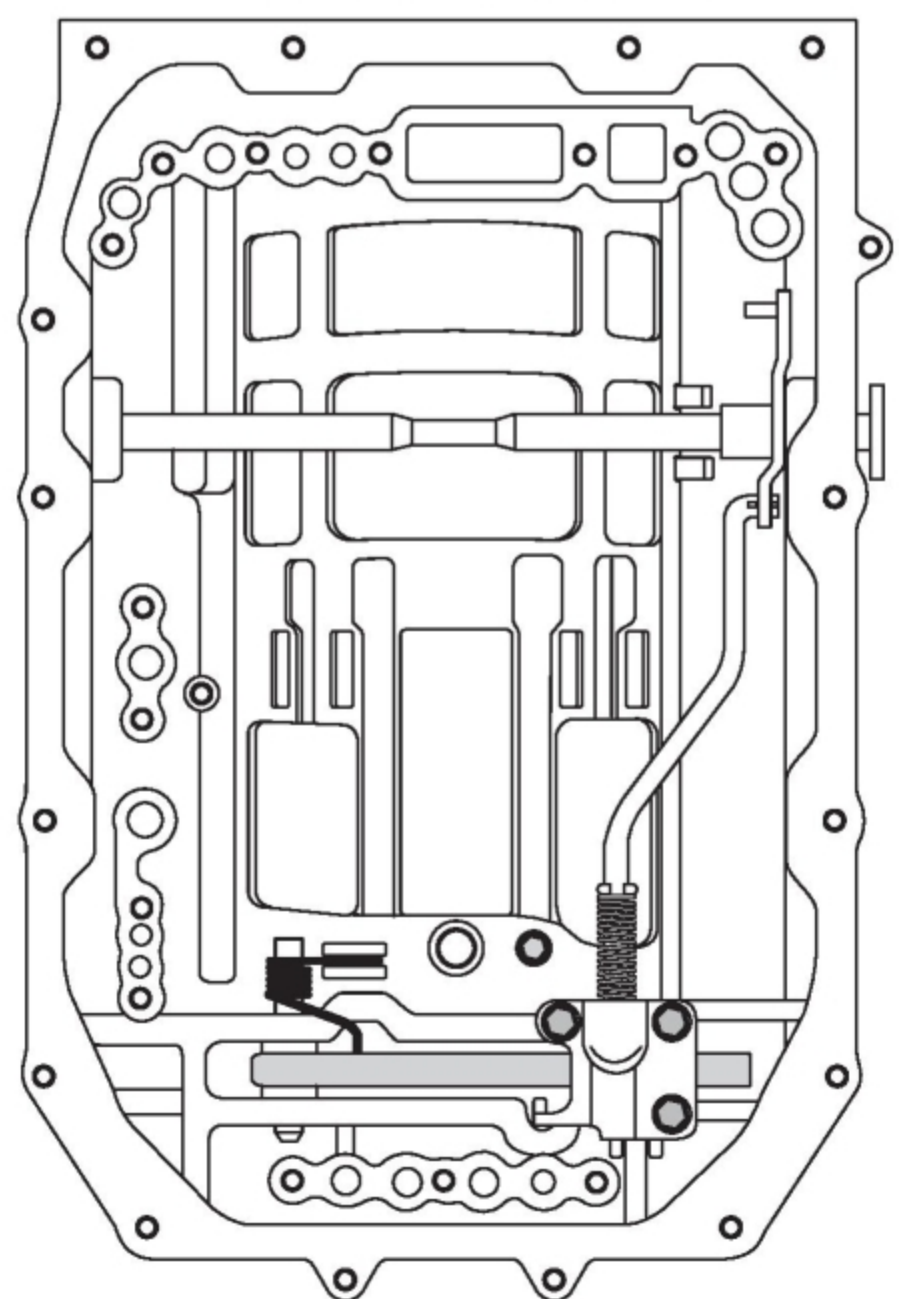
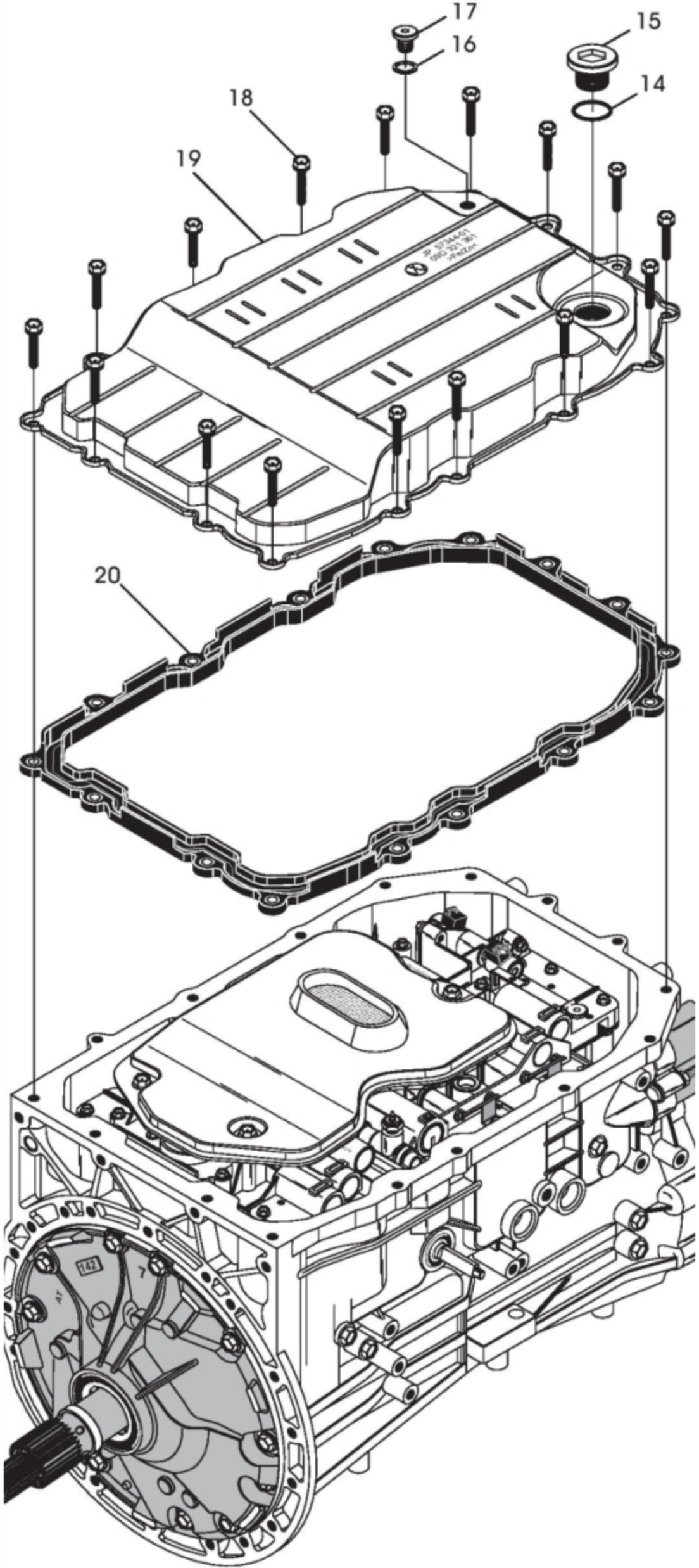
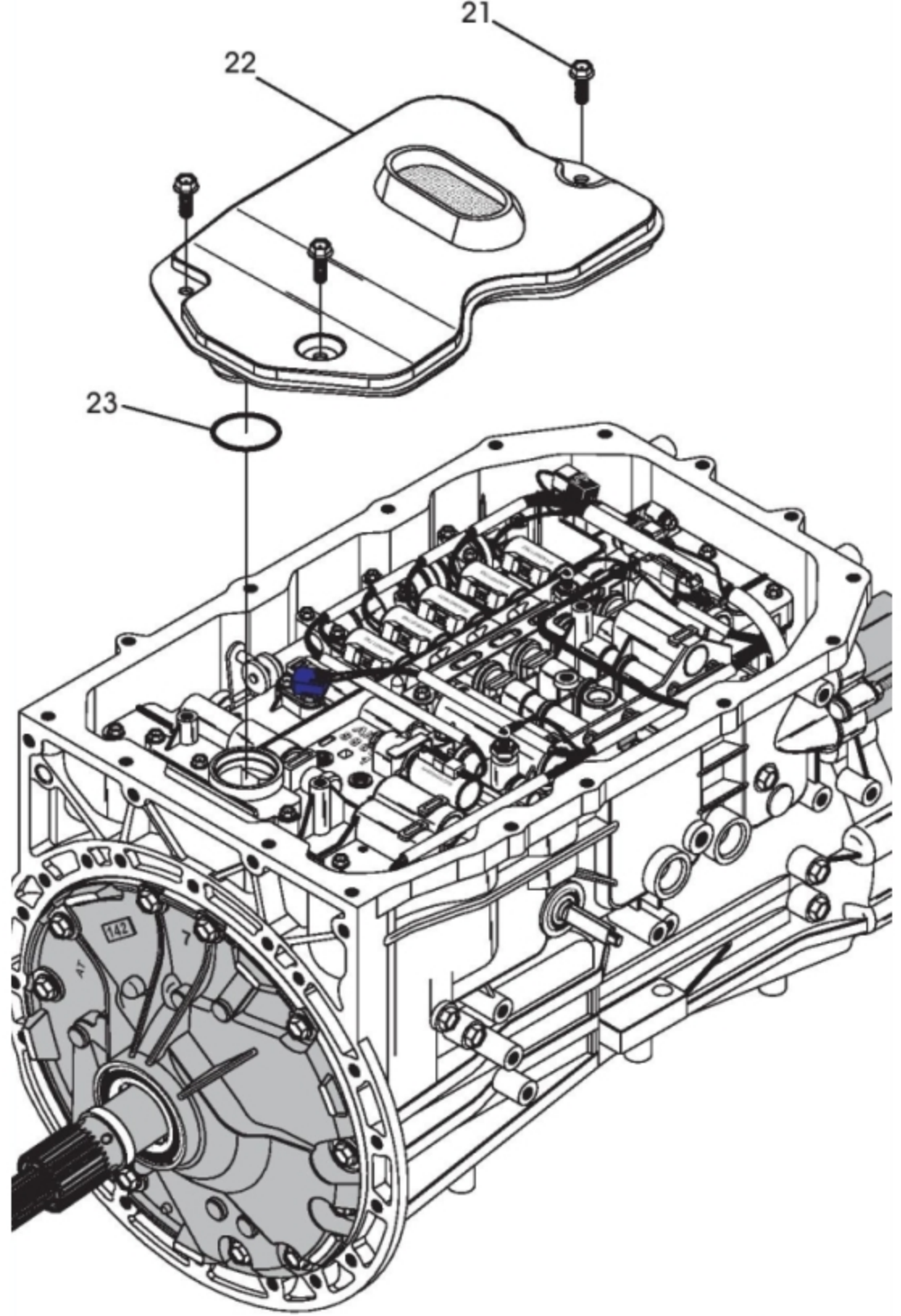

Fig.2



- 14 ATF CHECK PLUG "O" RING SEAL.
- 15 ATF CHECK PLUG.
- 16 OIL PAN DRAIN PLUG SEAL WASHER.
- 17 OIL PAN DRAIN PLUG.
- 18 OIL PAN RETAINING BOLTS, 24 MM (.945"), 8 OR 16 REQUIRED.
- 19 OIL PAN (MODEL SENSITIVE, 8 OR 16 RETAINING BOLTS).
- 20 OIL PAN GASKET (MODEL SENSITIVE, 8 OR 16 RETAINING BOLTS).

Fig.3



- 21 OIL FILTER RETAINING BOLTS, 12.0 MM (0.472") (3 REQUIRED).
- 22 OIL FILTER ASSEMBLY.
- 23 OIL FILTER TO VALVE BODY "O" RING SEAL.

Fig.4

OIL PAN MAGNET POSITIONS

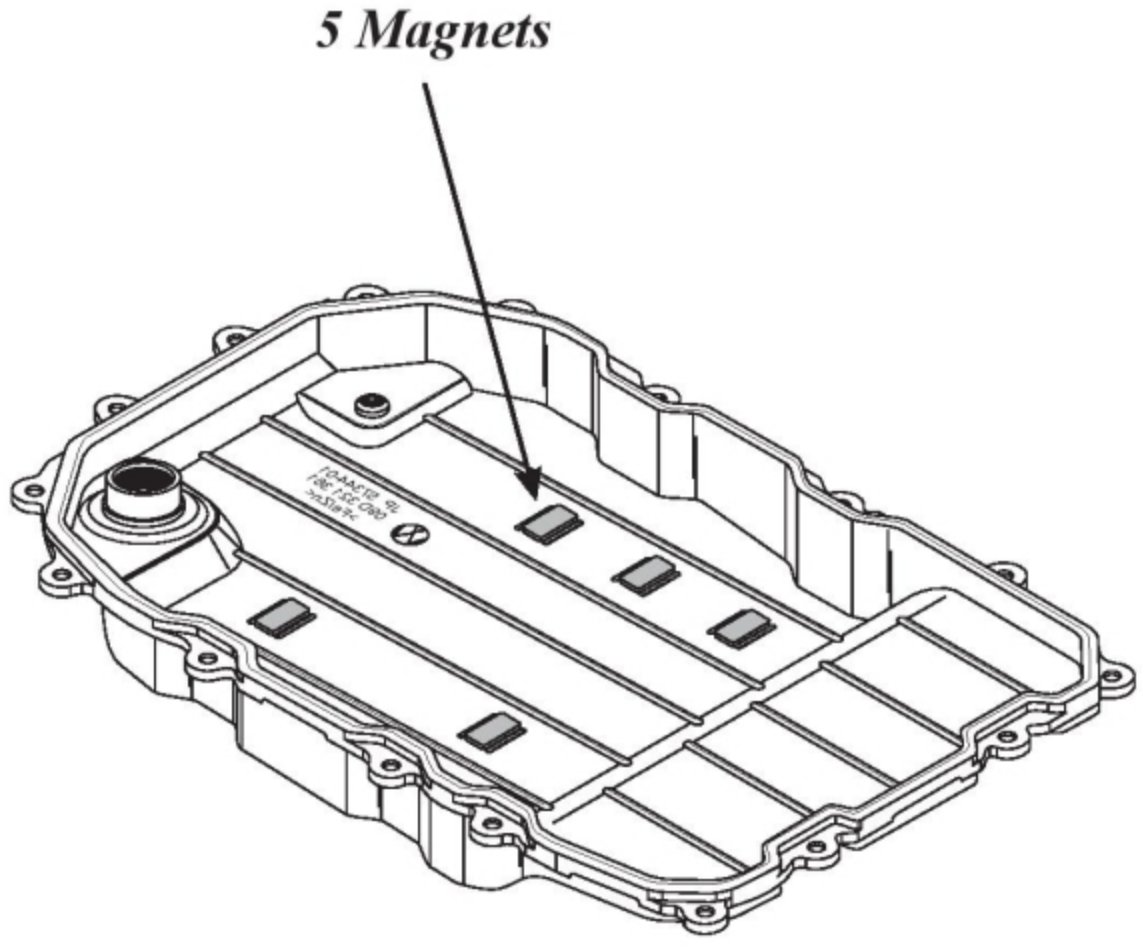

5 Magnets

Fig.5